

ACCESSORIES

- IRRIGATION/ASPIRATION
- EYE SHIELDS
- EYE SPEARS
- FLUID FILTERS
- INSTRUMENTS



IRRIGATION/ASPIRATION

BIMANUAL IRRIGATION

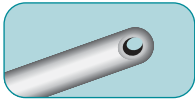

Code	Description	Contents
165514	21G x $\frac{5}{8}$ in. (0.8 x 16mm), curved tip, twin 0.5mm side ports	10/Box

BIMANUAL ASPIRATION

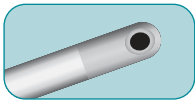

Code	Description	Contents
165512	21G x $\frac{5}{8}$ in. (0.8 x 16mm), curved micro etched tip, 0.3mm side port	10/Box

COAXIAL I/A, Regular Handle

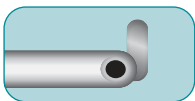
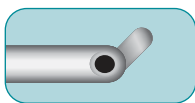
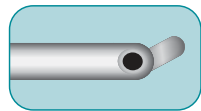

Code	Description	Contents
1685784	17G outer/23G inner (1.4/0.6mm), 45° tip	10/Box
1685785	17G outer/23G inner (1.4/0.6mm), 60° tip	10/Box
1685786	17G outer/23G inner (1.4/0.6mm), 90° tip	10/Box

EYE SHIELDS

UNIVERSAL, Adult Size

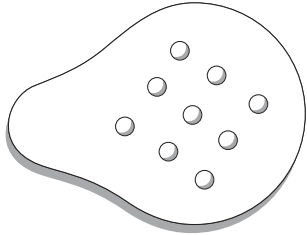

Code	Description	Contents
501040	Clear, sterile in pouch	50/Box
501041	Clear, non-sterile in bags	100/Bag

EYE SPEARS

PVA



Code	Description	Contents
504090	Sterile, 10 per pouch, 10 pouches per box	100/Box

FLUID FILTERS

HIGH FLOW .20 micron

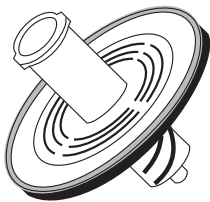

Code	Description	Contents
501030	Sterile, one per pouch	50/Box

INSTRUMENTS

MANIPULATORS

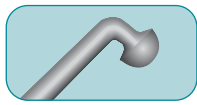

195070

Code	Description	Contents
195070	Dome tip	3/Box
195062	Hook (Sinsky) straight	3/Box
195063	Hook (Sinsky) angled	3/Box
195077	Nucleus Rotator, Y-shape	3/Box

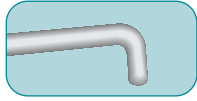

195062

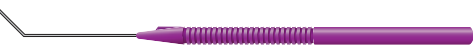
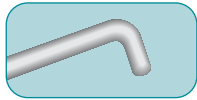

195063

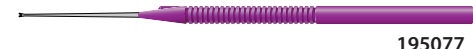

195077

CHOPPERS

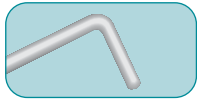

195181

Code	Description	Contents
195181	Koch	3/Box